

# TRANSFORMERS™

NOTE: Some parts are made to detach if excessive force is applied and are designed to be reattached if separation occurs. Adult supervision may be necessary for younger children.

NIGHTWATCH  
OPTIMUS PRIME™

STEALTH  
STARSCREAM™

AGES 5+

83457/83453 ASST.

TRANSFORMERS.COM

## CHANGING TO VEHICLE

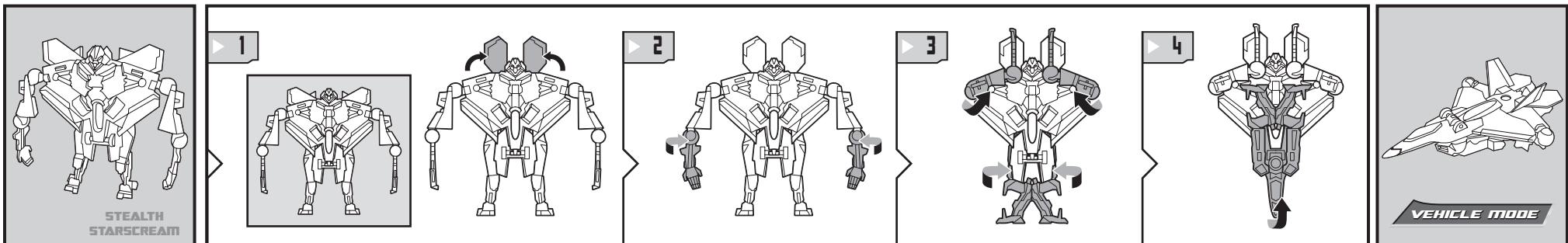
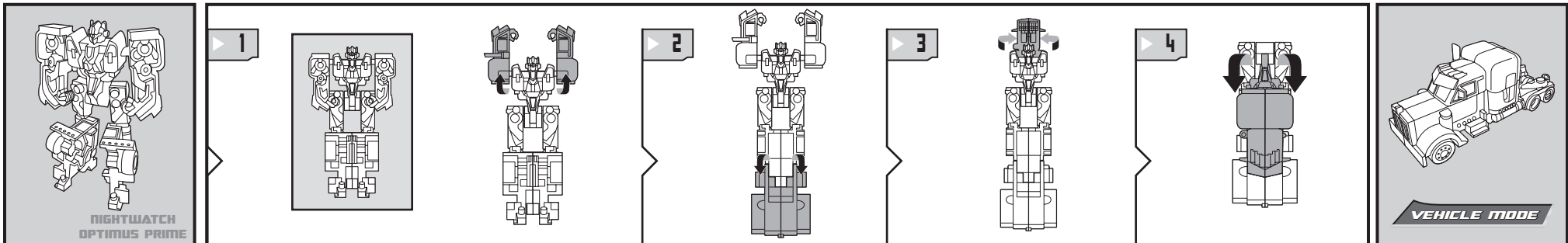

TRANSFORMERS.COM

Reverse order of instructions to convert back into robots.



® and/or TM\* & © 2007 Hasbro. All rights reserved. TM & © denote U.S. trademarks. Manufactured under license from Tomy Company, Ltd.

DREAMWORKS  
PICTURES

© 2007 DreamWorks LLC and Paramount Pictures Corporation



LOCKHEED MARTIN® F-22® Raptor®, associated emblems and logos, and body designs of vehicles are either registered trademarks or trademarks of Lockheed Martin Corporation in the USA and/or other countries, used under license by DreamWorks, LLC.

P/N 6750560000

Some poses may require hand support.



Not suitable for children under 3 years because of small parts - choking hazard.